



USER MANUAL



# Contents

01. Welcome to <b>HALO ONE®</b> Halotherapy .....	2
02. Intended Use .....	2
03. Safeguards .....	3
04. Safety Precautions .....	4
05. Packaging .....	5
06. <b>HALO ONE®</b> Unit .....	6
07. Installation .....	7
08. Operating the <b>HALO ONE®</b> .....	9
09. Cleaning and Care .....	12
10. Mesh Salt Emitter Replacement .....	14
11. Storage and Disposal .....	16
12. Troubleshooting .....	17
13. Warranty .....	18
14. Specifications .....	20

# 1. Welcome to HALO ONE® Halotherapy

## History of Halotherapy

Halotherapy has been popular in Europe for many decades after doctors discovered that workers in the local salt mines seemed to have few respiratory ailments when compared to the general public. During and after the Second World War people started spending time in the empty salt mines with good results. Some abandoned mines were eventually turned into clinics. As the understanding of Halotherapy grew and results were documented, specialized salt machines were designed to deliver fine salt particles into a room or enclosure to replicate the atmosphere of the mines. These machines have historically been very expensive. Spas and clinics started building entire halotherapy rooms made of blocks of salt brought up from these mines or from the Himalayas. Halotherapy was first identified as a healing modality in the spa industry around 2013 and has been a growing trend since. The **HALO ONE®** gives the user the opportunity to experience this healing salt regimen at home, anytime.

## HALO ONE® Halotherapy

The **HALO ONE®** has been designed and engineered to provide beneficial salt sessions for use in the home or sauna. The **HALO ONE®** is the only Halotherapy device available today that offers our unique and proprietary salt mist delivery system (patent pending). The **HALO ONE®** unit provides the optimal method to control the size and quantity of salt particles for ideal absorption. The intuitive and smart design sets the ahead of the field in both ease of use and effectiveness making it the preferred salt healing solution.

## 2. Intended Use

This **HALO ONE®** unit is intended for dry salt inhalation solely and strictly in accordance with this Manual including (without limitation) only using **HALO ONE®** salt capsules provided by the manufacturer. Users must comply with this Manual and any supplemental installation, operation and maintenance instructions provided by the manufacturer. Any other use of the **HALO ONE®** is not considered in accordance with these terms and the intended use. The manufacturer/supplier is not liable for any damage to persons and/or property that may arise from improper use. The user alone incurs this risk.

The **HALO ONE®** unit is designed to be used in a room up to 10'x10' (3.05m x 3.05m). The **HALO ONE®** can also be used inside a sauna up to a maximum temperature of 140°F (60°C) for no more than one consecutive hour. The **HALO ONE®** unit is not designed for continuous use in the sauna and should be removed after each use if the sauna is used for multiple sessions in a day.

The **HALO ONE®** unit will provide a fine salt mist in any room or sauna where it is operated. Care should be taken to cover, seal and/or remove any electronic equipment or objects that could be affected by fine salt particles. Please let common sense guide you when choosing which rooms to use the **HALO ONE®**. With normal use, the **HALO ONE®** should not cause any problems to the room environment, but manufacturer/supplier assumes no liability or responsibility for any claims or damages that may arise except as expressly set forth in the **HALO ONE®** warranty.

### 3. Safeguards



During a single session, the **HALO ONE®** can distribute approximately 20ml of 3% saline in aerosol form. Saline mist can have a corrosive effect on various materials such as metal, concrete and electronic devices. Those items may be damaged as a result and should not remain near the **HALO ONE®** while in operation.

- The **HALO ONE®** can be mounted to a wall or placed on a level and flat surface. When wall mounting the unit, please make sure it is level.
- Only use saline capsules provided by **HALO ONE®**. Using other solutions may have adverse effects on functionality and damage the device.
- We recommend regular cleaning and vacuuming of surfaces in the room the unit is operated in to remove any salt dust.
- The **HALO ONE®** can be operated when plugged in to an electrical outlet or using the internal rechargeable battery. Please ensure that the operating environment is within specifications indicated in this manual.

## 4. Safety Precautions



Please read the following thoroughly before using the **HALO ONE®**:

- The **HALO ONE®** is not intended for use by persons (including children) with reduced physical, sensory or mental capabilities, or lack of experience and knowledge, unless they have been given supervision or instruction concerning use of the appliance by a person responsible for their safety.
- Please install the unit according to the installation instructions.
- Do not damage or modify the power adapter and USB charging cable.
- Do not install the power adapter or cable if damaged.
- Do not pull on the cable when unplugging the power adapter or from unit.
- Do not plug in or unplug the adapter or the cable with wet hands.
- Do not drop the unit or subject it to shock.
- Do not modify the unit. Also, no one other than an authorized service technician should take apart or repair the unit.
- Do not touch the metal blade inside the capsule holder opening, to avoid personal injury.
- Keep out of reach of children from 8 years or below.
- The **HALO ONE®** is only to be used and charged with the power adapter provided.
- The unit contains batteries that are only replaceable by an authorized technician.
- **HALO ONE®** is intended for use at temperature between 10°C and 60°C (50°F and 140°F). Do not leave it in environment above 60°C (140°F).
- Do not use liquid other than **HALO ONE®** saline solution. Doing so may damage the device and may be hazardous to the user.
- Do not use excessive force when touching any metal outlets. Doing so may cause the unit to malfunction.
- Do not use if the unit itself, the power adapter or charging cable are damaged or defective.



### WARNING

Read this manual carefully and completely and retain for future reference.  
Failure to adhere to safety instructions may result in serious injury or damage.

## 5. Packaging

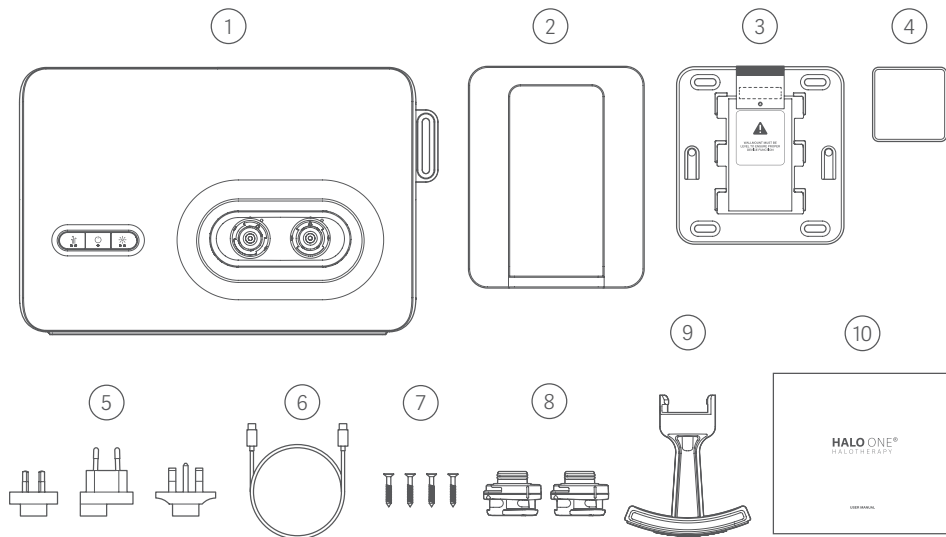

- |                              |                                   |                                  |
|------------------------------|-----------------------------------|----------------------------------|
| 1 HALO ONE® Main Unit        | 5 Optional Plug (region specific) | 8 Mesh Salt Emitter Replacements |
| 2 Wall Mount Bracket (front) | 6 USB-C Cable                     | 9 Hand Tool                      |
| 3 Wall Mount Bracket (back)  | 7 Wall Mount Screw X4             | 10 User Manual                   |
| 4 Power Adapter              |                                   |                                  |

## 6. HALO ONE® Unit

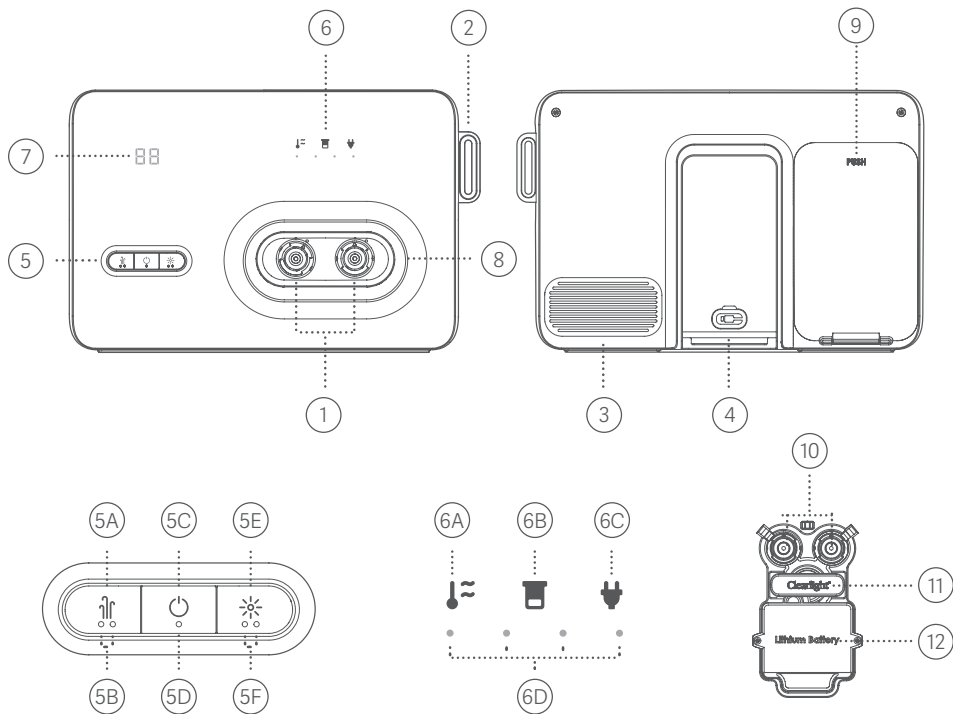



## Main Unit

- |                         |                 |
|-------------------------|-----------------|
| 1 Mesh Salt Emitters    | 3 Air Inlet     |
| 2 Saline Capsule Holder | 4 Charging Port |

## User Interface

- |                               |   |
|-------------------------------|---|
| 5 Control Panel               | 5D Device Status Indicator                |
| 5A Fan Switch                 | 5E Emotive Light Switch                   |
| 5B Fan Hi/Lo Indicator        | 5F Emotive Light Operation Mode Indicator |
| 5C Power Switch               |   |
| 6 Indicator Panel             | 6C Charging Indicator                     |
| 6A Overheating Indicator      | 6D Battery Level Indicator                |
| 6B Empty Water Tank Indicator |   |
| 7 Timer                       | 10 Mesh Salt Emier Replacements           |
| 8 Emotive Light               | 11 Hand Tool                              |
| 9 Door Compartment            | 12 Li-ion Baery Compartment               |

# 7. Installation

## Wall Mount

The **HALO ONE®** can be installed on a wall using the included wall mount. Care should be taken to make certain that the wall chosen for installation of the mounting bracket does not contain electrical lines or water pipes directly behind where the screws will be inserted.

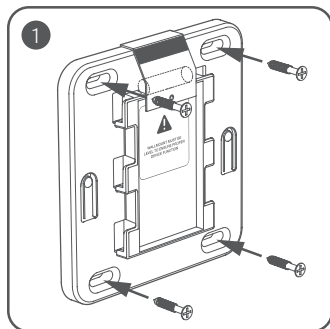

1 Screw the wall bracket to the desired wall using the included screws

**\* Ensure that wall mount base is level using the included level**

When using the unit in a sauna we recommend removing the level from the wall mount

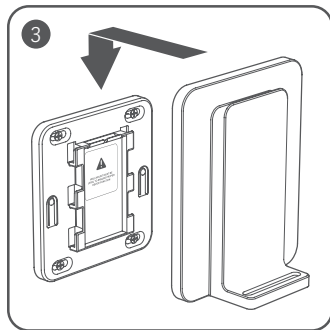
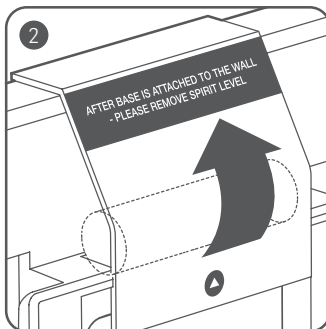

3 Attach the wall mount cover to the bracket

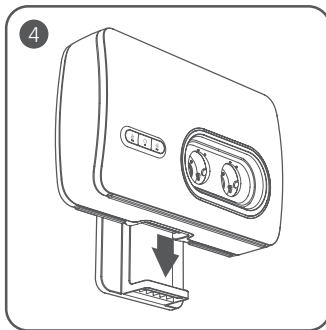

4 Dock the main unit onto the wall mount

## Tabletop Placement

The **HALO ONE®** can be run while placed on any flat and stable surface. We recommend placing the unit a minimum of three feet or higher from the floor for maximum dispersion of the salt.

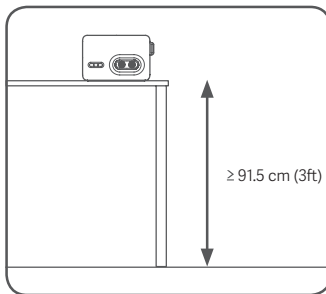
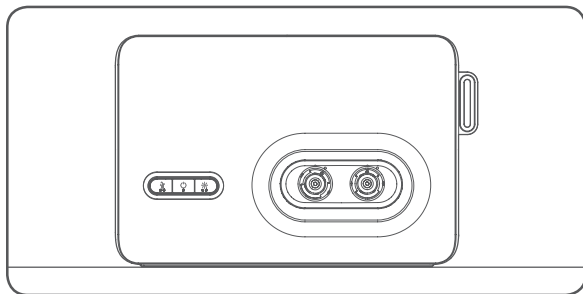

## 8. Operating the HALO ONE®

### Starting a new session



When the power adapter is not connected the unit will automatically turn off in 1 minute if it is not operating, to conserve the battery life.

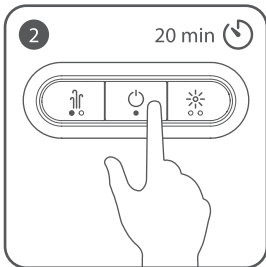

To turn on the **HALO ONE®**, press and hold the POWER button for 2 seconds.

- The unit is now in Stand-By mode.
- Press the POWER button one more time and the unit will turn on.
- The status indicator is blue when the unit is on.
- The timer will start counting down.

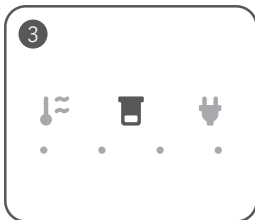

**If the unit's internal saline solution level is low or empty, the session will not start:**

- The status indicator will blink blue.
- The empty tank indicator will turn on.

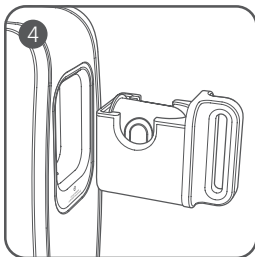

**When the unit is empty:**

- Remove the saline capsule holder and remove the empty capsule if still in the unit.
- Place one saline solution capsule into the holder.
- Insert the capsule holder back into the device.
- The empty tank indicator will turn off.

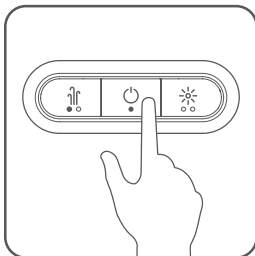

**Pausing A Session**

- The session stops automatically when the water tank is empty.
- You can also press and hold the POWER button for 2 seconds to pause your session.

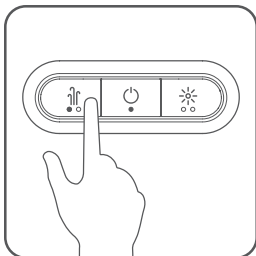

### Fan Control

- The internal fan increases the saline mist distribution.
- When the session starts the fan is set to low speed.
- Toggle the fan speed between high and low by pressing the fan button.
- The fan speed indicator changes accordingly.

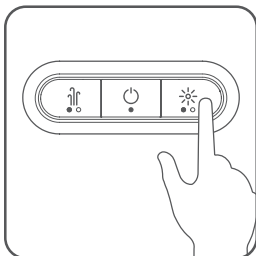

### Emotive Light Control

- The relaxing emotive light works in 3 modes:
  - a. Breathing
  - b. On
  - c. Off
- When the session starts the emotive light defaults to breathing mode.
- Press the emotive light button to cycle through the different modes.
- The indicator will change accordingly.

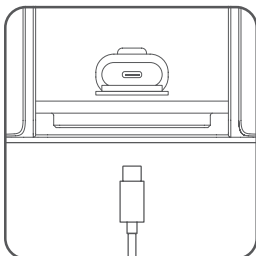

### Charging The HALO ONE®

- Connect the USB-C cable to the power adapter.
- Open the rubber cover that conceals the charging port and insert the end of the USB-C cable into the unit.
- Plug the power adapter into an electrical outlet.
- The unit is charging when the battery level indicator blinks.
- When the unit is fully charged, the charging indicator will turn off and the battery level indicator will stop blinking.

## 9. Cleaning and Care

### Clean After Every Use:

- After each use, clean the unit to maintain its performance and longevity.

### Brush the Emitter:

- Use the small cleaning brush included with your saline capsule pack.
- Gently brush around the emitter to remove any salt.
- Avoid touching the mesh center of the emitter, as it can be easily damaged.

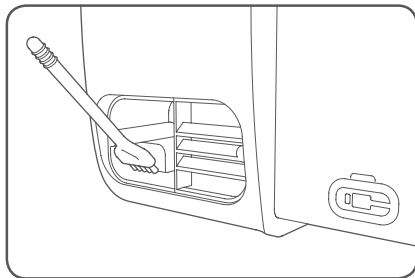
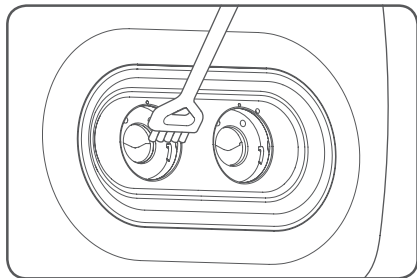

### Clean the Air Inlet:

- Brush the air inlet at the back of the unit to remove any residual salt.

### Remove and Drain the Saline Capsule:

- Remove the used saline capsule from the unit.
- Drain any remaining solution from the unit.

### Rinse and Dry:

- Rinse the water reservoir with clean water.
- Allow it to air dry completely before using the unit again.

### For Best Results:

- We recommend using a cleaning capsule after every 20 uses.
- Refer to the instructions on pages 9 and 10 of this manual for detailed steps on how to use the cleaning capsule.

- Use a clean soft cloth with a neutral detergent or lukewarm water to clean the capsule holder opening.

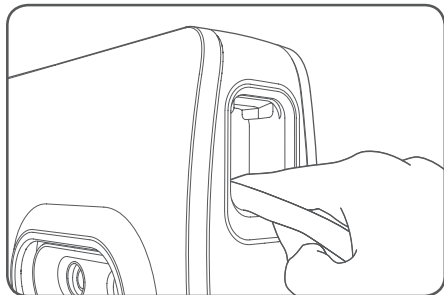

**DO NOT** touch or push the metal outlet nozzle with excess force.

Doing so may damage the unit.

**Important Note:**

**DO NOT** submerge the unit in water. This will damage the unit.

**Warning:**

- Micro-organisms that may be present in the water or the environment where the appliance is used or stored can grow in the water reservoir and be blown into the air, causing serious health risks if the water is not renewed and the tank is not cleaned properly every 3 days.
- It is recommended to clean the water tank every three days, exercise precautions, and follow the instructions below.

**How to Deep Clean Your Halo One:**

- Turn off and unplug the unit. Remove the saline capsule holder. Drain the remaining solution from the unit. Prepare a solution with 20mL of distilled water and 10 drops of pure white vinegar. Fill the water reservoir with the mixed solution. Turn on the Halo One and let it run for 3-5 minutes, allowing the vinegar to disperse throughout. Turn off and unplug the unit, and drain the water reservoir completely. Rinse the water reservoir with clean distilled water. Allow the water reservoir to air dry in a clean environment before using the unit again.

**Additional Precautions:**

- High humidity levels may encourage the growth of biological organisms in the environment. Ensure the area around the Halo One remains dry. If dampness occurs, reduce the output of the humidifier.
- Do not allow absorbent materials, such as carpeting, curtains, drapes, or tablecloths, to become damp.
- Never leave water in the reservoir when the Halo One is not in use.
- Empty and clean the water reservoir before storage. Clean the Halo One before the next use.
- Do not touch the two metal parts of the mist outlets directly or wipe them with a cloth.

## 10. Mesh Salt Emitter Replacement

• If one or both of the Mesh Salt Emitters become clogged or damaged, you can easily replace them:

### 1. Locate Replacement Emitters:

Two Mesh Salt Emitter replacements are located in the back of the device.

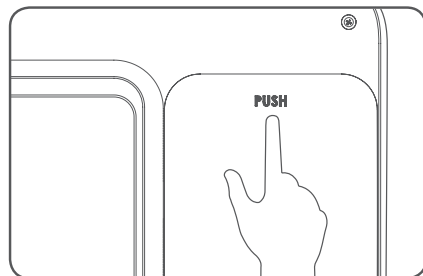

### 2. Open the Battery Door:

Push the battery door open.  
Remove Hand Tool and Emitter.

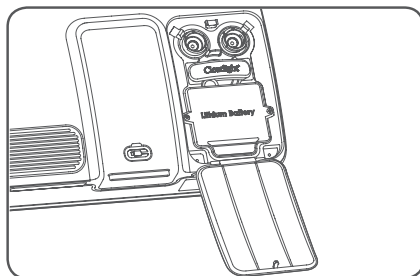

### 3. Take out the hand tool and emitter(s):

Be careful not to touch the mesh center of the emitter, as it is very delicate.

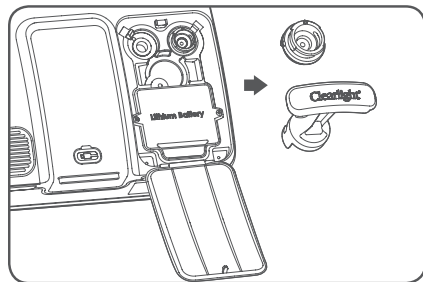



#### 4. Remove the Clogged or Damaged Emitter:

- Align the hand tool with the lock position of the emitter.
- Insert the hand tool into the emitter.
- Rotate the hand tool 45° clockwise.
- Remove the damaged mesh emitter and dispose.

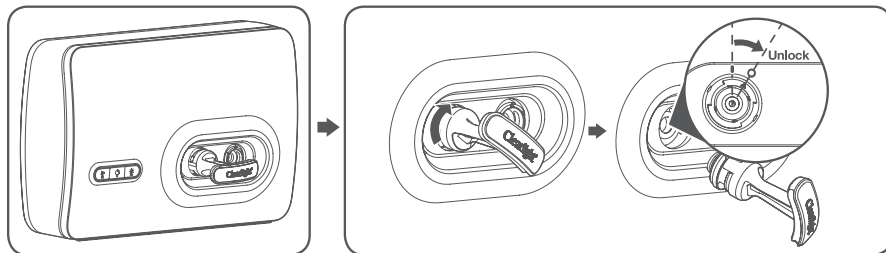

#### 5. Insert the New Mesh Salt Emitter:

- Clamp the new emitter using the hand tool.
  - Align the symbols.
  - Insert the emitter.
  - Turn 45° counterclockwise to the lock position.
  - Remove the hand tool and return it to the back of the device.
6. Close the battery door.

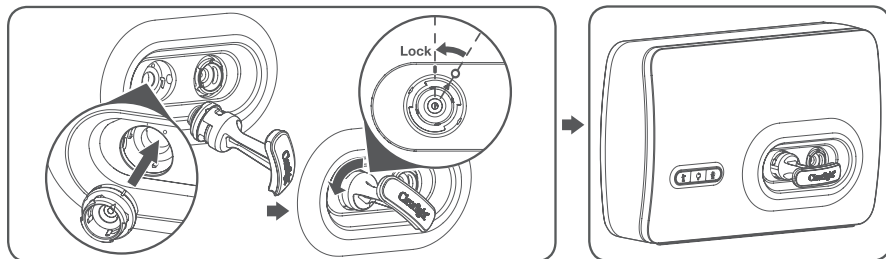

## 11. Storage and Disposal

If you will not be using the unit for a prolonged period, please store the unit after performing the following procedure:

1. Unplug the power adapter and charging cable if connected.
2. Remove the saline capsule holder and empty out all of the saline solution still in the device.
3. Leave the unit open overnight so the internal parts can dry.
4. Do not store this product in areas with high temperatures or humidity.

Please dispose of this product and packaging in accordance with local regulations. The battery should be removed from the product before disposal.

Dispose of or recycle the battery and packaging materials in accordance with local ordinances or regulations.

## 12. Troubleshooting

Check the following if the product appears to be broken or operating abnormally.  
Please contact us at [support@clearlightsaunas.co](mailto:support@clearlightsaunas.co) if you have any questions about your unit.

<b>No power. The product won't turn on</b>	<b>Is the battery discharged?</b> <ul style="list-style-type: none"><li>• Plug in the power adapter to charge the device Is the power adapter correctly connected?</li><li>• Check if the power adapter/cable is connected to unit and the electrical outlet</li><li>• Check if you are using the power adapter/cable supplied with the unit</li></ul>
<b>Unit turns on for a short time, then turns off</b>	<b>Is there enough saline solution in the water tank?</b> <ul style="list-style-type: none"><li>• Insert a new capsule</li></ul> <b>Is the battery discharged?</b> <ul style="list-style-type: none"><li>• Check the battery level indicator</li><li>• Plug in the power adapter to charge the device</li></ul>
<b>The unit turns on, but you cannot start a new session</b>	<b>Is there enough saline solution in the water tank?</b> <ul style="list-style-type: none"><li>• Check indicator and replace capsule if necessary</li></ul> <b>Is the environment too hot or too cold?</b> <ul style="list-style-type: none"><li>• Check if the over temperature indicator is on</li><li>• Remove the device from hot / cold environment</li></ul> <b>Is the battery discharged?</b> <ul style="list-style-type: none"><li>• Check the battery level indicator, the device is designed so that it cannot be started if the battery level is too low to protect the battery</li></ul>
<b>The product will not charge</b>	<b>Is the power adapter correctly connected?</b> <ul style="list-style-type: none"><li>• Check if the power adapter/cable is connected to unit and the electrical outlet</li><li>• Check if you are using the power adapter/cable supplied with the unit</li></ul> <b>Is the environment too hot or too cold?</b> <ul style="list-style-type: none"><li>• Check if the over temperature indicator is on</li><li>• Remove the device from hot / cold environment</li></ul>

## 13. Warranty

Clearlight® sells its products with the intent that they are free of defects in manufacture and workmanship for a period of ONE year (AU, NZ, UK) and TWO years (EU) from the date of original purchase, except as noted below. Clearlight® warrants that its products will be free of defects in material and workmanship under normal use and service. This warranty extends only to consumers and does not extend to Retailers. To obtain warranty service on your Clearlight® product, contact a customer relations representative for assistance. Please make sure to have the model number of the product available.

Clearlight does not authorize anyone, including, but not limited to Retailers, the subsequent consumer purchaser of the product from a Retailer or remote purchasers, to obligate Clearlight in any way beyond the terms set forth herein. This warranty does not cover damage caused by misuse or abuse; accident; the attachment of any unauthorised accessory; alteration to the product; improper installation; unauthorised repairs or modifications; improper use of electrical/power supply; loss of power; dropped product; malfunction or damage of an operating part from failure to provide manufacturer's recommended maintenance; transportation damage; theft; neglect; vandalism; or environmental conditions; loss of use during the period the product is at a repair facility or otherwise awaiting parts or repair; or any other conditions whatsoever that are beyond the control of Clearlight®.

This warranty is effective only if the product is purchased and operated in the country in which the product is purchased. A product that requires modifications or adoption to enable it to operate in any other country than the country for which it was designed, manufactured, approved and/or authorized, or repair of products damaged by these modifications is not covered under this warranty.

THE WARRANTY PROVIDED HEREIN SHALL BE THE SOLE AND EXCLUSIVE WARRANTY. THERE SHALL BE NO OTHER WARRANTIES EXPRESS OR IMPLIED INCLUDING ANY IMPLIED WARRANTY OF MERCHANTABILITY OR FITNESS OR ANY OTHER OBLIGATION ON THE PART OF THE COMPANY WITH RESPECT TO PRODUCTS COVERED BY THIS WARRANTY. CLEARLIGHT® SHALL HAVE NO LIABILITY FOR ANY INCIDENTAL, CONSEQUENTIAL OR SPECIAL DAMAGES. IN NO EVENT SHALL THIS WARRANTY REQUIRE MORE THAN THE REPAIR OR REPLACEMENT OF ANY PART OR PARTS WHICH ARE FOUND TO BE DEFECTIVE WITHIN THE EFFECTIVE PERIOD OF THE WARRANTY. NO REFUNDS WILL BE GIVEN. IF REPLACEMENT PARTS FOR DEFECTIVE MATERIALS ARE NOT AVAILABLE, CLEARLIGHT® RESERVES THE RIGHT TO MAKE PRODUCT SUBSTITUTIONS IN LIEU OF REPAIR OR REPLACEMENT.

This warranty does not extend to the purchase of opened, used, repaired, repackaged and/ or resealed products, including but not limited to sale of such products on Internet auction sites and/ or sales of such products by surplus or bulk resellers. Any and all warranties or guarantees shall immediately cease and terminate as to any products or parts thereof which are repaired, replaced, altered, or modified, without the prior express and written consent of Clearlight®.

This warranty provides you with specific legal rights. You may have additional rights which may vary from country to country. Because of individual country regulations, some of the above limitations and exclusions may not apply to you.

#### **WARRANTY SERVICE**

Contact Information:

Please visit [support.clearlightsaunas.co](http://support.clearlightsaunas.co) for online troubleshooting information.

# 14. Specifications

Product name	HALO ONE®
External Dimensions	25cm L x 33cm W x 10 cm (9 3/4" L x 13" W x 4" D)
Unit Weight (Main Unit)	1.4 kg (3 lb)s
Power Source	1. Dedicated 45W USB PD power adapter Power supply 100~240V AC 50/60Hz Output: 15V 3A 2. Internal 5000mAh Lithium battery
Operating Temperature	10°C ~ 40° C (50°F ~ 104°F)
Main Unit Power Consumption	Approximately 35W
Main Unit Material	PC/ABS
Accessories	Wall Mount Bracket, Power Adapter, Optional Plug (region specific), USB-C Cable, Screws, User Manual

## Distributed by

Clearlight Saunas Australia P/L  
2/78 Rajah Road,  
Ocean Shores,  
NSW 2483  
Australia  
P: +61 2 9000 1975  
clearlightsaunas.com.au

Clearlight Saunas UK Ltd  
Unit 1, West Links, Tollgate  
Business Park, Chandlers Ford,  
Hampshire SO53 3TG United  
Kingdom GB262269595  
clearlightsaunas.co.uk  
P: 2380 012 067

Clearlight Saunas Europe GmbH  
C/O LPA-GGV  
Herrengarten 3  
20459 Hamburg  
Germany  
clearlightinfrarotkabinen.de  
P: + 040 40110120

**Manufactured and  
Distributed by:**

Clearlight Infrared  
1077 Eastshore Hwy  
Berkeley, CA 94710 USA  
+1-510-601-1775  
info@infraredsauna.com

© 2025 Clearlight Infrared

This device complies with part 15 of the FCC Rules. Operation is subject to the following two conditions:  
(1) This device may not cause harmful interference, and (2) this device must accept any interference received, including interference that may cause undesired operation.

Changes or modifications not expressly approved by the party responsible for compliance could void the user's authority to operate the equipment.

**"HALO ONE"** and the **HALO ONE** logo are the trademark of Clearlight Sauna

**HALO**ONE®  
HALOTHERAPY